

# SEMI-AUTOMATIC WRAPPING MACHINE SPINNY S300/S350



# KWIKPAC PRESENTS THE SPINNY S300 & SPINNY S350

**THE USER FRIENDLY, AFFORDABLE, RELIABLE AND FULLY CUSTOMIZABLE MACHINE THAT WILL LET YOU REACH HIGH STANDARDS IN PACKAGING.**

## Main Features

With its **10** wrapping programs, is equipped with a motorized pre-stretch system that allows a sensible saving of film while wrapping. The machine has **10** password protected programs and, on request, is also available with **5** pre-set programs.

- Pre-stretch up to **300%**
- Pallet height detection with photocell
- Distance between column and turntable **500mm**
- Rotating table movement regulated by variable frequency drive
- Rotating table stop in position controlled by sensor
- Variable speed of film carriage completely customizable
- Working cycle controlled by PLC and electronic card

Extremely customizable and available with many optionals to fit all the customer's needs. **Versions: TP** (hand pallet jack), **PRESS** (top press), **DUO** (double table), **TOUCH** (touch screen control panel, standard in S350),

STAINLESS STEEL, DUAL MOTORS (with Dual Motor Pre-stretch system) or for DOORS & WINDOWS packaging are only few of the customizations available for SPINNY S300.



## PRE-STRETCH SYSTEM = ECONOMIC ADVANTAGE

All models are equipped with an high-performance **MOTORIZED PRE-STRETCH SYSTEM**. The power pre-stretch is a special device which allows the best utilization of the stretch film quantity; moreover, it permits to wrap light and unsteady pallets that couldn't be wrapped with different frictioning systems. The stretch film is supplied in the right quantity by the rollers that are operated by a motor, which is controlled by an electronic system that measures the speed and keeps the film tension constant on the whole pallet's surface. The motorized pre-stretch system, allows an efficiency of film up to **300%**.

## SPINNY DUAL MOTOR gives you even more!

The **DUAL MOTOR** version is designed to let you save even more film, obtaining more economic advantages. Based on the same principle of the single motor version, with the **DUAL MOTOR** system, SPINNY S300 offers variable stretch factor up to **400%**!

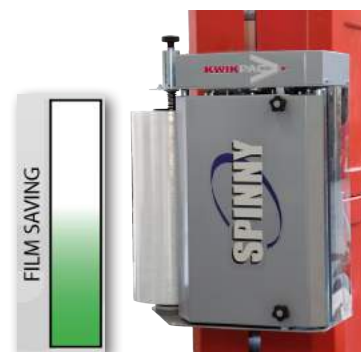

Kwikpac Limited,  
Randolph Court  
Randolph Industrial Estate  
Kirkcaldy, Fife, KY1 2YY  
Tel: 01592 650 700  
Web: [www.kwikpac.co.uk](http://www.kwikpac.co.uk)

# SPINNY S350 WITH TOUCH SCREEN CONTROL PANEL

**YOUR NEXT WRAPPING MACHINE ...  
GOING ONE STEP BEYOND**



Kwikpac Limited,  
Randolph Court  
Randolph Industrial Estate  
Kirkcaldy, Fife, KY1 2YY  
Tel: 01592 650 700  
Web: [www.kwikpac.co.uk](http://www.kwikpac.co.uk)



**CONTACT US FOR INFO ON ALL VERSIONS  
AND ACCESSORIES AVAILABLE WITH  
SPINNY S300 AND SPINNY S350**

**Email:** [sales@kwipac.co.uk](mailto:sales@kwipac.co.uk) | **Web:** [www.kwikpac.co.uk](http://www.kwikpac.co.uk) | **Call today on:** 01592 650700



## TECHNICAL DATA

- The standard machine is designed to wrap palletted loads with stretch plastic film having the dimension up to 1200 mm (L) X 800 mm (W), with a load capacity of 1200 kg.
- The turntable is also available with a diameter of 1500 mm, 1650 mm, 1800 mm and 2200 mm with a load capacity of 2000 kg.
- The column can be furnished to wrap pallets with heights of 2100 mm, 2600 mm and 3100 mm.
- Table rotation speed and film carrier speed are regulated by inverter (turntable can rotate at a speed from 5 to 10 RPM).

Kwikpac Limited,  
Randolph Court  
Randolph Industrial Estate  
Kirkcaldy, Fife, KY1 2YY  
Tel: 01592 650 700  
Web: [www.kwikpac.co.uk](http://www.kwikpac.co.uk)

## ELECTRICAL SUPPLY

- Tension: 230 V single phase or, on demand, 400-415 V triple phase  $\pm 10\%$
- Frequency: 50 Hz
- Installed power: 1,3 kW
- Auxiliary energy supply: 24 V DC

## FILM (LLDPE) AND COIL CHARACTERISTICS

- Thickness: 15 ÷ 40  $\mu\text{m}$
- Advised thickness: 23  $\mu\text{m}$
- Internal coil diameter: 76 mm
- Height: 500 mm
- Maximum film roll weight: 16 kg
- Maximum external coil diameter: 250 mm

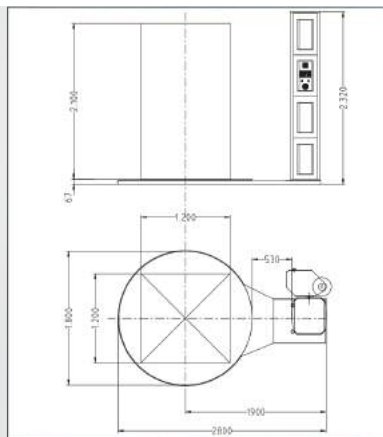
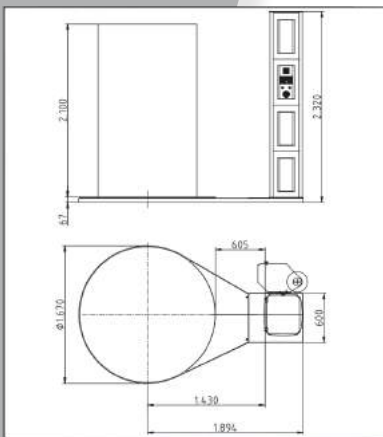
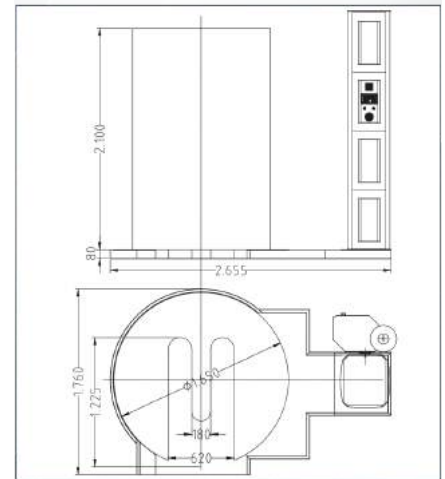
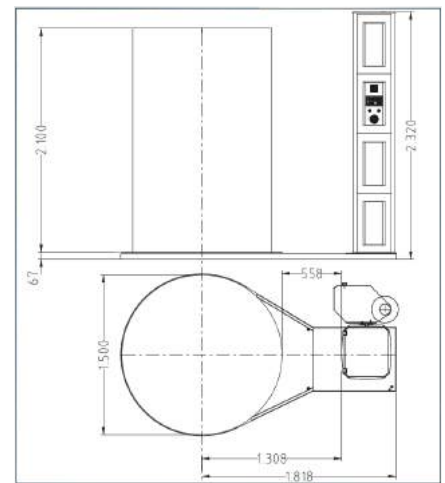

**WWW.KWIPAC.CO.UK**  
**ORDER ONLINE TODAY**